

Cabinet for the HIU 2 Home Water Control Station

Installation and Operating Manual

(translated from the original Operating Manual)

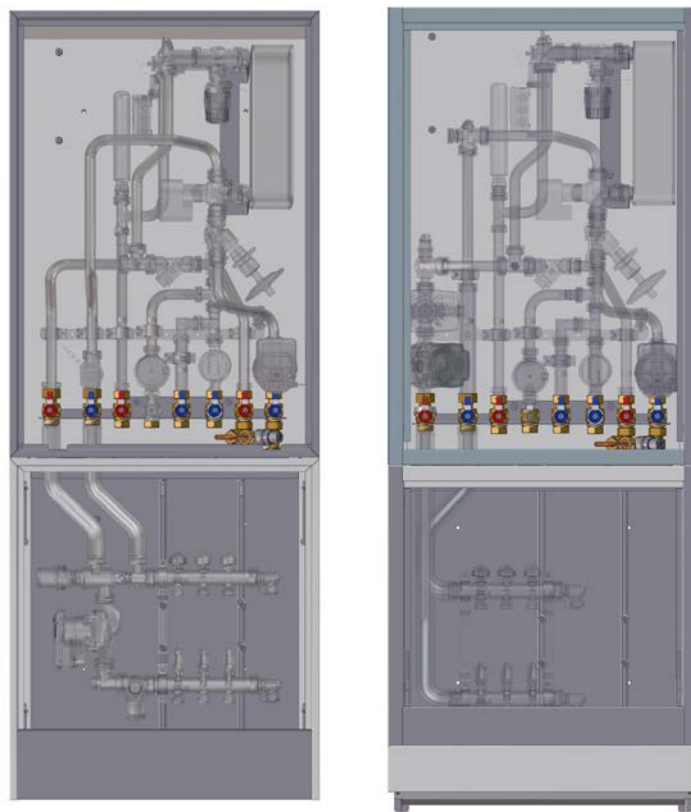

Contents

| | |
|--|-----------|
| 1 General information | 2 |
| 1.1 Important information about this Installation and Operating Manual | 2 |
| 1.2 Product features..... | 2 |
| 2 Safety..... | 3 |
| 2.1 Description of safety signs | 3 |
| 2.2 Important safety information | 3 |
| 2.3 Intended use | 3 |
| 2.4 Foreseeable misuse | 3 |
| 2.5 Responsibilities of the operator..... | 3 |
| 2.6 Personnel groups..... | 4 |
| 3 Installation and commissioning | 4 |
| 3.1 Wall mounting..... | 4 |
| 3.2 Installation of the HIU 2 cabinet without manifold cabinet | 5 |
| 3.3 Installation of the HIU 2 cabinet with manifold cabinet..... | 8 |
| 3.4 Installation variants..... | 11 |
| 4 Disposal..... | 12 |
| 4.1 Return to the manufacturer | 12 |
| 4.2 Notification of administrative bodies and the manufacturer.... | 12 |
| 5 Warranty..... | 12 |

1 General information

1.1 Important information about the Installation and Operating Manual

NOTICE

The plant operator is responsible for ensuring compliance with the local laws and regulations (e.g. accident prevention regulations, etc.).

In the event of improper use or operation of the system outside the specifications, any warranty claim expires.

This Installation and Operating Manual

- is an integral part of the cabinet
- contains instructions and information for the safe and proper installation and commissioning of the cabinet
- must be available to any user throughout the life of the cabinet
- is intended for instructed personnel who are familiar with the applicable standards and regulations and in particular with the relevant safety concepts and the operation and maintenance of the cabinet
- is protected by copyright and may not be altered without the manufacturer's permission
- may not be made accessible to unauthorized persons, either in original form or as a copy.

1.2 Product features

- Stable casing made of plated steel
- all connections to the G 1" system and the G 3/4" system have flat sealing
- Compact, space-saving design
- Modular construction allowing connection to cabinets provided for this purpose

2 Safety

2.1 Description of safety signs

▲ DANGER DANGER indicates an imminent danger that may cause serious physical injury or death if the appropriate safety precautions are not in place.

▲ WARNING WARNING indicates a danger arising through incorrect behavior (e.g. misuse, disregarding of notices, etc.) that may cause serious physical injury or death.

▲ CAUTION CAUTION indicates a potentially dangerous situation that may cause minor or slight injuries if the appropriate safety precautions are not in place.

NOTICE NOTE indicates a situation that may cause material damage if the corresponding precautions are not taken.

2.2 Important safety information

- Read these operating instructions carefully before use.
- Maintenance, cleaning and repair work may be carried out by trained specialist personnel only.
- If the cabinet is damaged or is not operated properly, it may no longer be used. In this case, contact your specialist dealer immediately.
- Observe the maintenance instructions and intervals.
- Protect the cabinet from the elements.
- Never use the cabinet outdoors.
- The cabinet may be used only in accordance with the intended use.

2.3 Intended use

Cabinet for the installation of the HIU 2 Home Water Control Station and hydraulic accessories.

The cabinet is not intended to be used by persons (including children) with limited physical, sensory, or mental abilities, or a lack of expertise and experience.

2.4 Foreseeable misuse

The following is considered to be foreseeable misuse:

- Operating the cabinet outside specifications
- Improper use of the cabinet
- Changes to the cabinet that were not discussed with the manufacturer
- Use of replacement or wear parts that were not approved by the manufacturer
- Operating the cabinet out of doors (components are not UV-resistant)

2.5 Responsibilities of the operator

The plant operator must ensure that:

- the cabinet is used only as intended
- the cabinet is installed, operated, and maintained in accordance with the instructions in the Installation and Operating Manual (translated from the original operating manual)
- the cabinet is operated according to local health and safety regulations
- all precautions are taken to avoid possible dangers from the cabinet
- all precautions for first aid and firefighting have been taken
- only authorized and trained users have operational access to the cabinet
- users have access to this installation and operating manual at all times

2.6 Personnel groups

Only qualified persons may install and operate the cabinet and carry out maintenance work.

Operators

Operators are deemed to be qualified if they have read these operating instructions and understood the potential hazards associated with improper behavior.

Installation/commissioning engineer

An installation/commissioning engineer is in a position to carry out work on the cabinet, taking into account the relevant standards, regulations, rules, and laws—as well as their professional training and specialist knowledge—and can recognize and avoid potential hazards.

3 Installation and commissioning

NOTICE The cabinet may be installed and commissioned only by trained personnel authorized by the manufacturer.

3.1 Wall mounting

NOTICE For wall mounting, suitable mounting hardware must be used.

HIU 2 Home Water Control Station Cabinet, surface-mounted
[order number 10078486 / type HIU 2A-2]

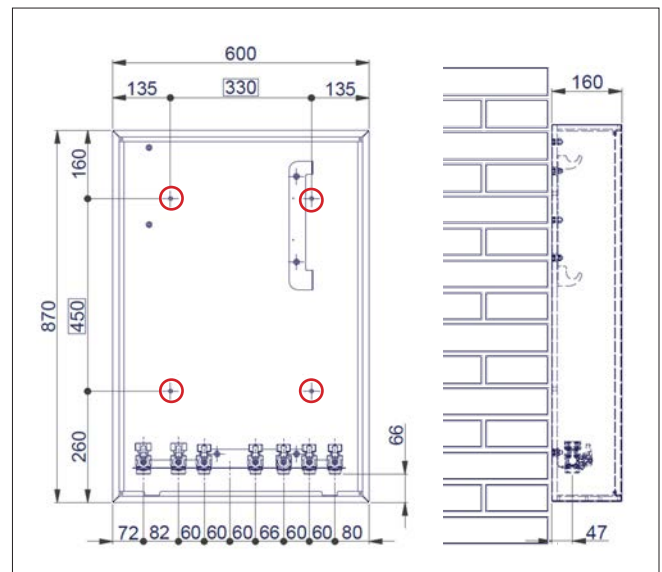

HIU 2 Home Water Control Station Cabinet, concealed
[article number 10078499 / type HIU 2U-2]

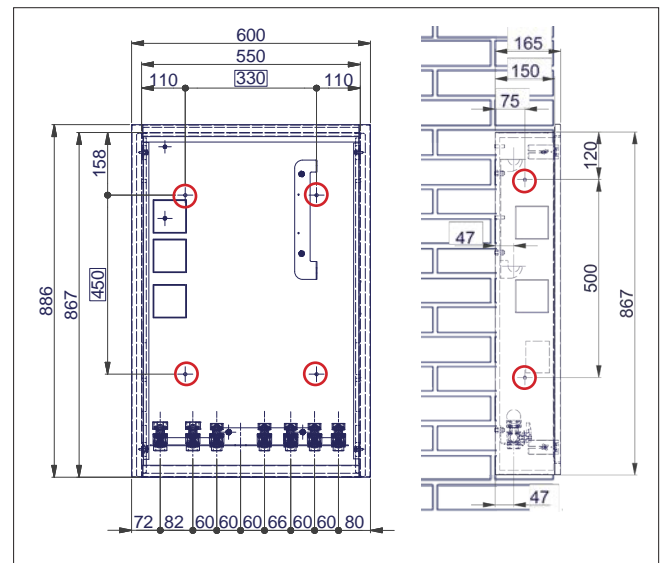

HIU 2 Manifold Cabinet, surface-mounted

| Item number | Type | a [mm] | b [mm] |
|-------------|--------|--------|--------|
| 10079243 | VSHA-2 | 600 | 300 |
| 10079244 | VSHA-3 | 750 | 450 |
| 10078487 | VSHA-4 | 900 | 600 |
| 10079246 | VSHA-5 | 1100 | 800 |

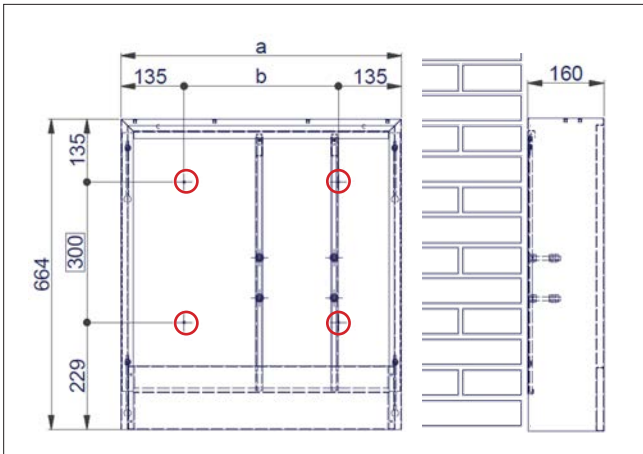

HIU 2 Manifold Cabinet, concealed

| Item number | Type | a [mm] | b [mm] | c [mm] |
|-------------|--------|--------|--------|--------|
| 10079156 | VSHU-2 | 600 | 550 | 330 |
| 10079245 | VSHU-3 | 750 | 700 | 480 |
| 10078488 | VSHU-4 | 900 | 850 | 630 |
| 10079247 | VSHU-5 | 1100 | 1050 | 830 |

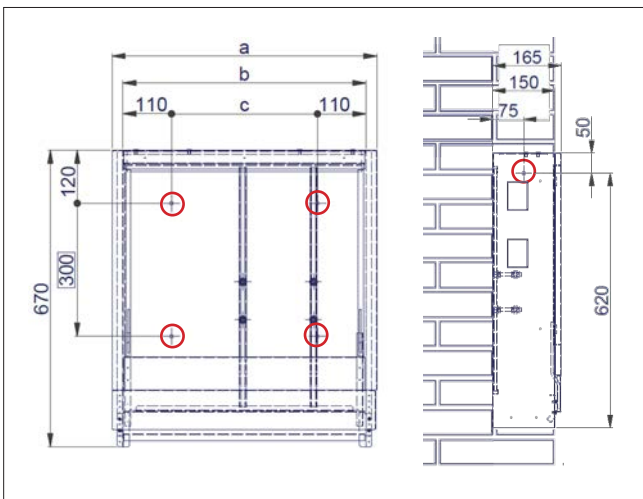

NOTICE

Before commissioning, all screw fittings must be checked and, if necessary, tightened!

Torque:

- 3/4" screw fittings 35 Nm
- 1" screw fittings 55 Nm

3.2 Installation of HIU 2 cabinet, without control cabinet

1. Mount the cabinet (see installation diagram on Seite 4).



- 1 Supply heating circuit
- 2 Return heating circuit
- 3 Domestic hot water outlet
- 4 Domestic water circulation inlet
- 5 Domestic cold water outlet
- 6 Domestic cold water inlet
- 7 Primary supply
- 8 Primary return

2. Optional: Install circulation bridge.

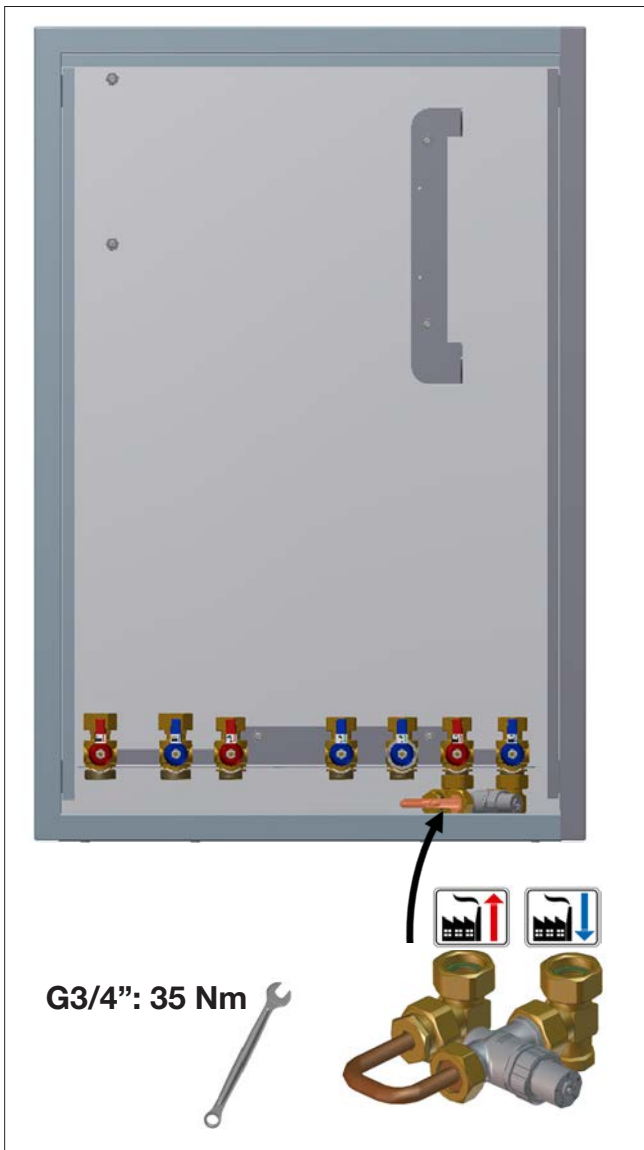

3. Connect pipes.

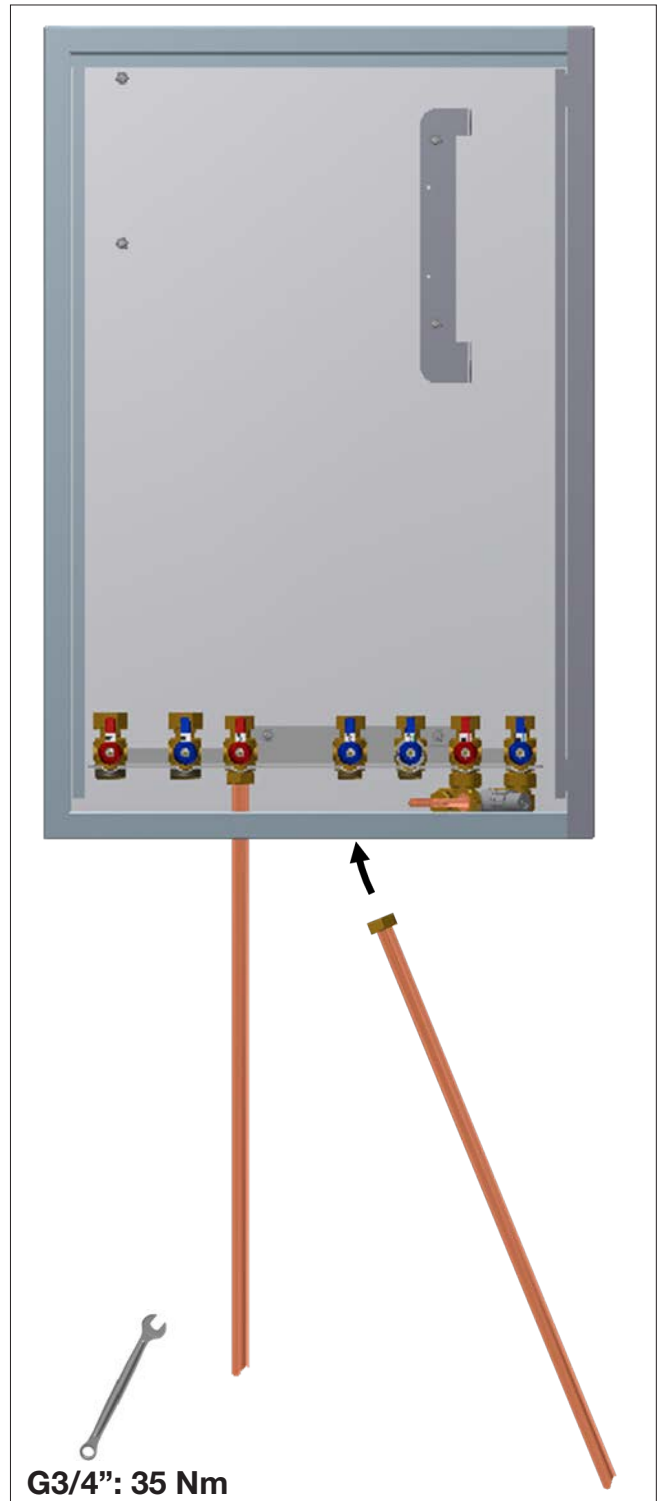

4. Install the HIU 2 Home Water Control Station.

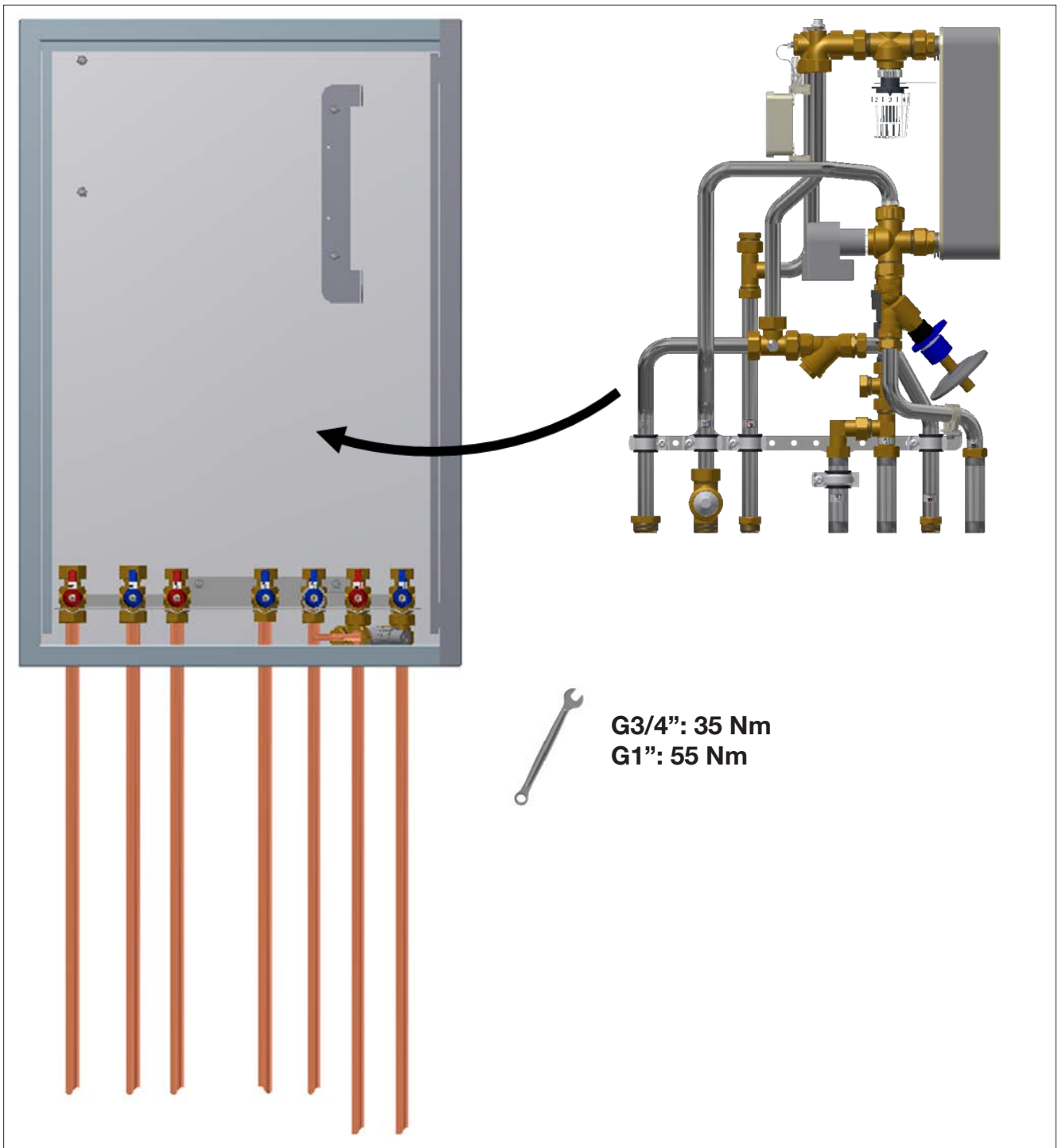

3.3 Installation of HIU 2 cabinet, with manifold cabinet

1. Install manifold cabinet (see installation diagram on Seite 4).
2. Screw the Home Water Control Station to the HIU 2 manifold cabinet.

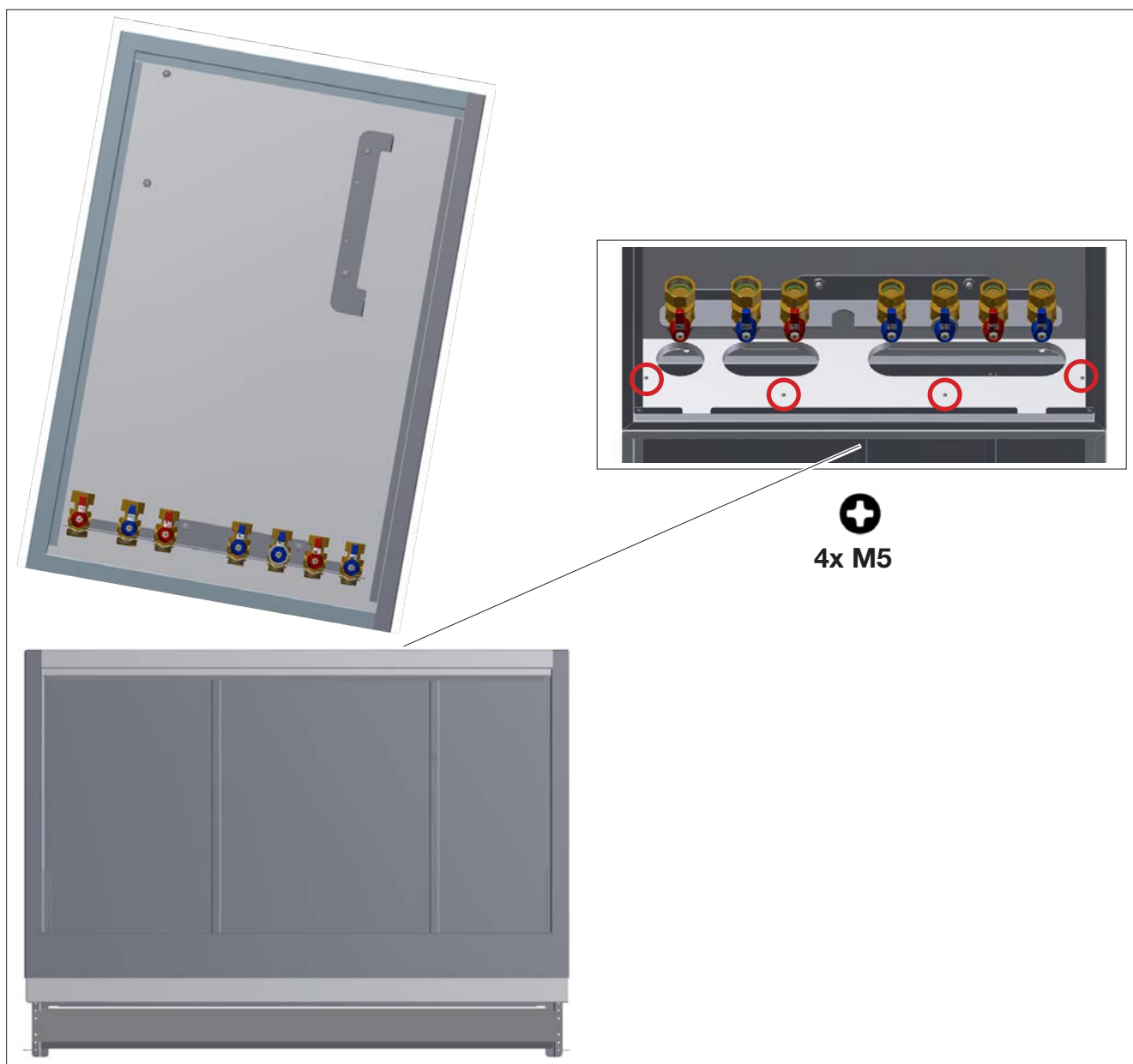

3. Optional: Install circulation bridge.

4. Connect pipes.

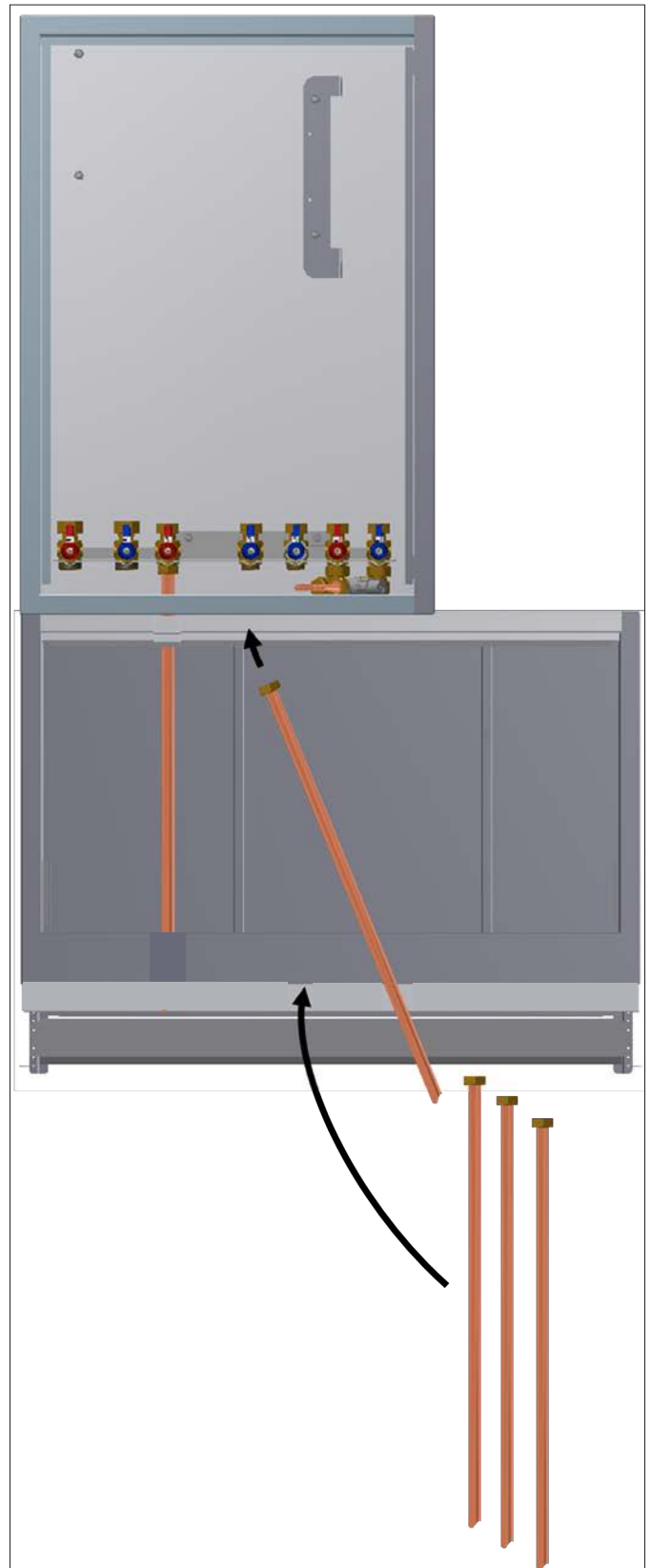
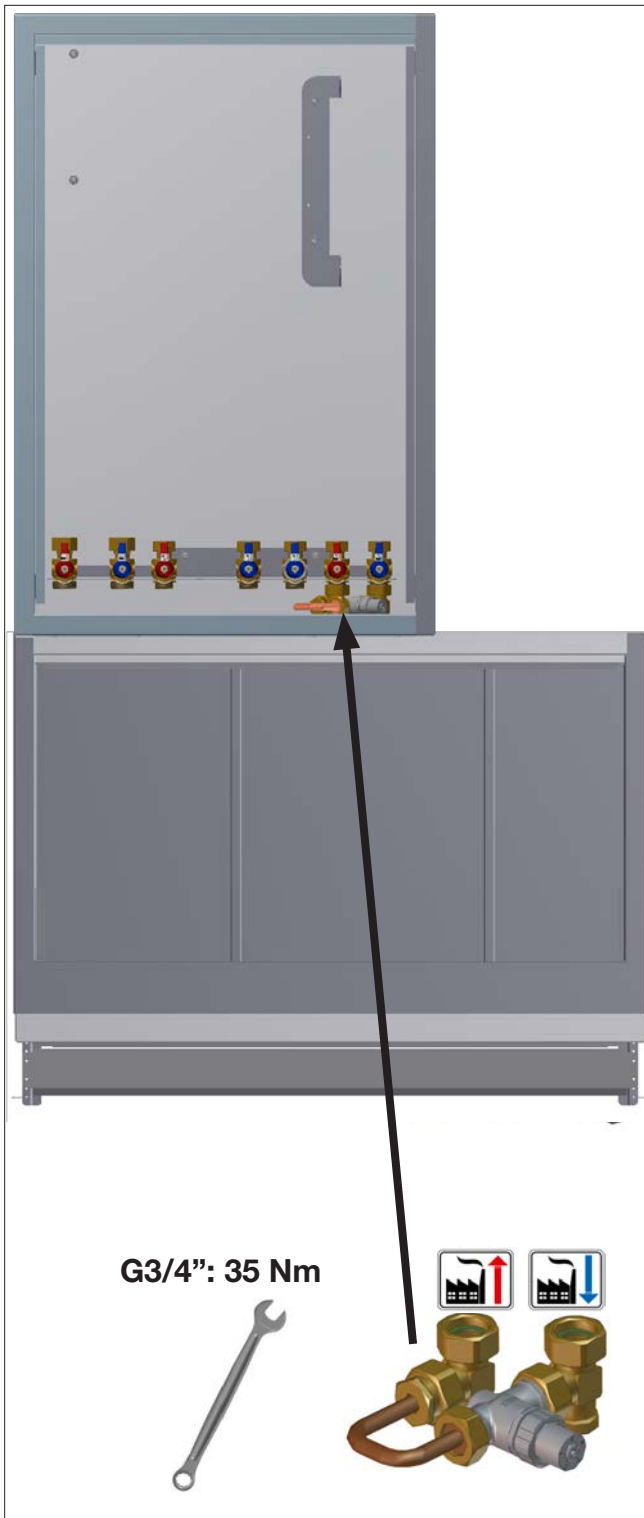

5. Fit distributor, Isomix, end set, and connection piping (further details can be taken from the instructions of the respective connection set).
6. Fit distributor, Isomix, end set, and connection piping to the connection rail.

7. Insert the HIU 2 Heat Interface Unit the cabinet and connect it to the connecting rail (for further details, refer to the HIU 2 instructions).

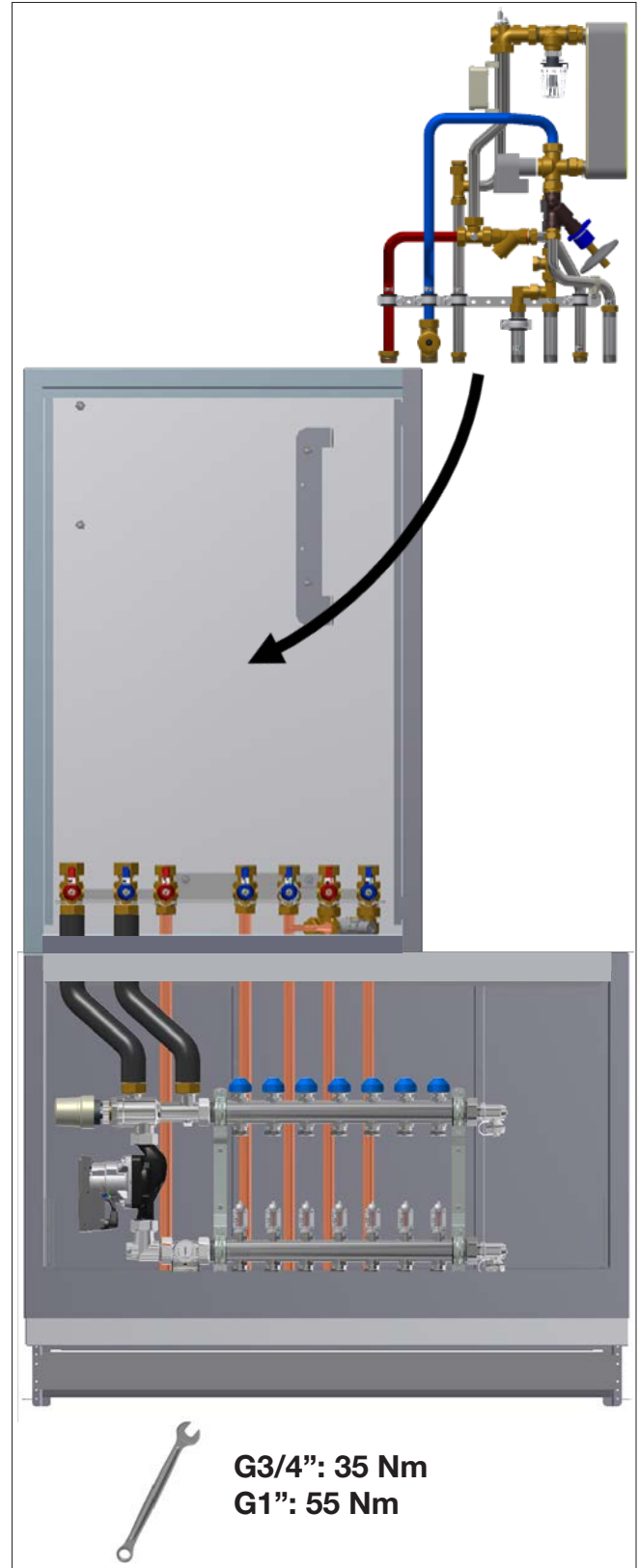
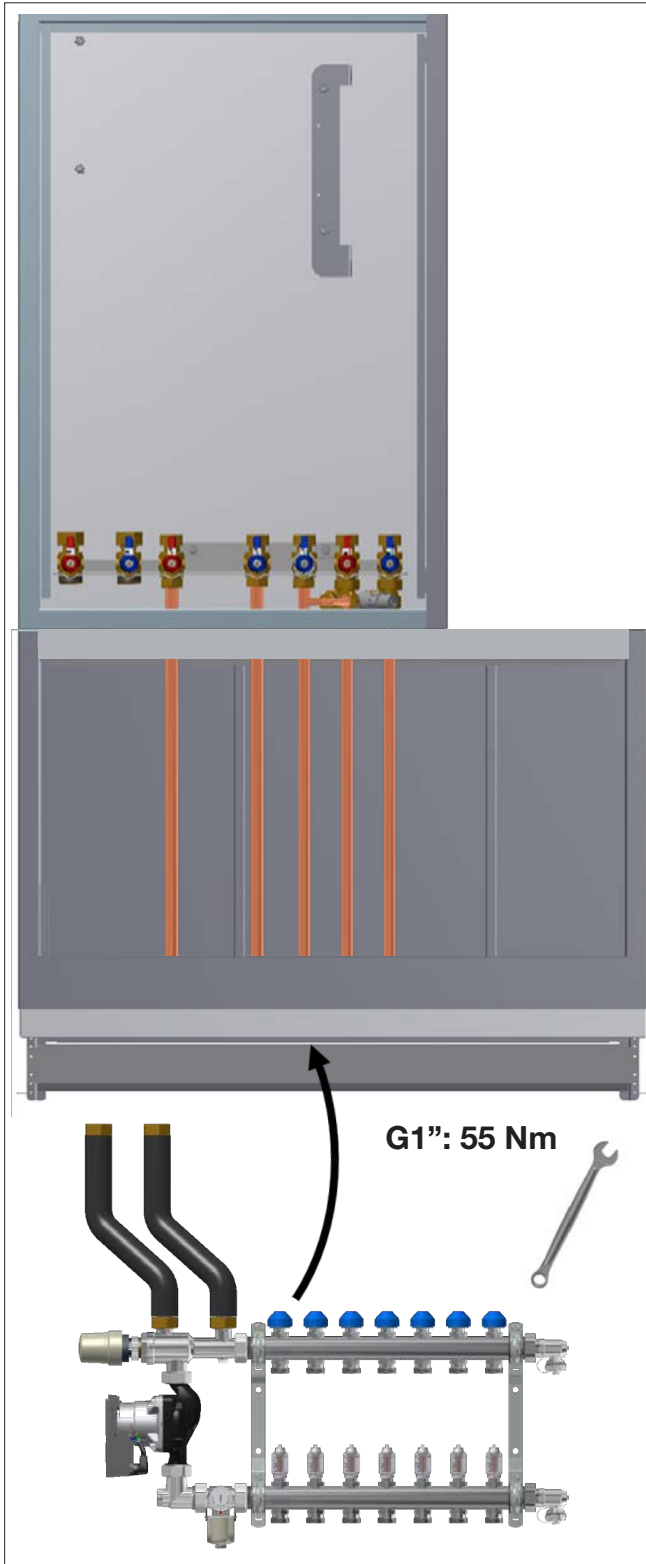

3.4 Installation variants

HIU 2A-2 + VSHA-x cabinets

HIU 2 HK (Isomix)

Display without HIU 2 Heat Interface Unit

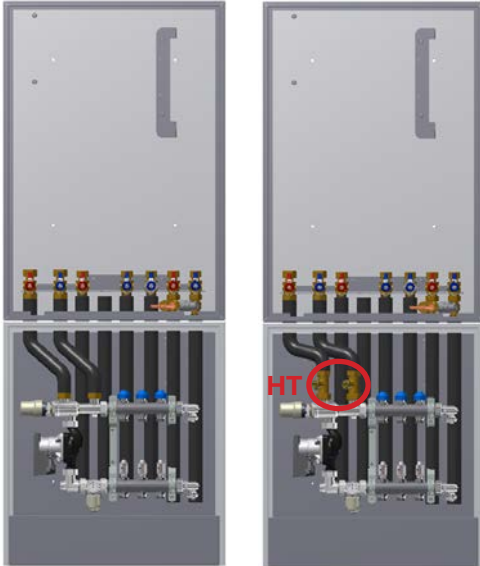

HIU 2 HKM

Display without HIU 2 Heat Interface Unit



HIU 2 HK (Isomix)

Display with HIU 2 Heat Interface Unit

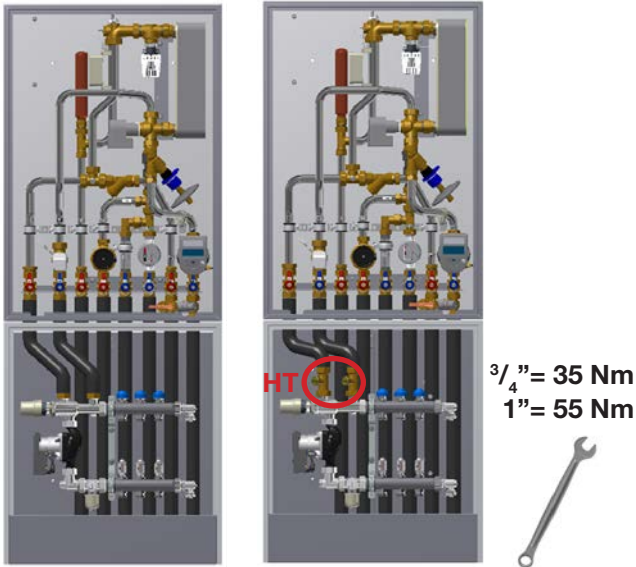

HIU 2 HKM

Display with HIU 2 Heat Interface Unit

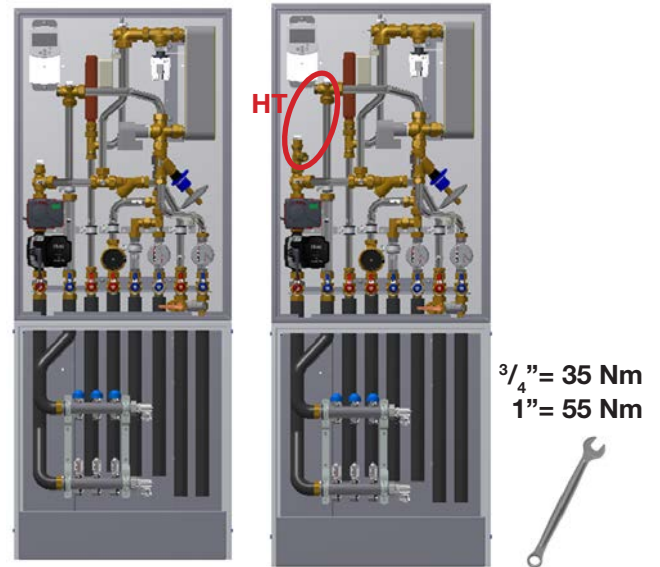

4 Disposal

▲ WARNING

Potential for contamination of the environment and groundwater from improper disposal!

The legal regulations and guidelines in the country of operation must be observed when disposing of components and operating materials.

1. Disassemble the cabinet expertly or commission a specialist company with this task.
2. Sort the assemblies and component parts into recyclable materials, hazardous substances and operating materials.
3. Dispose of the assemblies and components in accordance with local laws and regulations or take them to be recycled.

4.1 Return to the manufacturer

Contact the manufacturer if you would like to return the cabinet or parts thereof.

4.2 Notification of administrative bodies and the manufacturer

Inform the manufacturer about decommissioning and disposal of the cabinet for statistical purposes.

5 Warranty

WATTS products are tested extensively. WATTS therefore guarantees only to replace or – at the sole discretion of WATTS – to repair components of the products supplied free of charge if, in the opinion of WATTS, they exhibit verifiable manufacturing faults. Warranty claims due to defects or defects of title may be asserted within one (1) year of delivery/transfer of risk. Excluded from the warranty is damage attributable to normal product use or friction and to damage resulting from modifications or unauthorized repairs to the products, for which WATTS rejects all claims for compensation (direct or indirect). (For more detailed information, please refer to our website.) In all cases, supply is subject to the General Terms and Conditions, which can be found on www.wattswater.de.